

Getting to Earlham Institute



By car.

From the A47

- Take the A47 Southern Bypass towards Norwich (East) until the B1108 (Watton Rd) Junction
- At the junction with B1108 branch left (signposted Norwich) and at the roundabout take 1st exit signposted Norwich, University of East Anglia
- Turn right at the second set of traffic lights and then right into the Norwich Research Park (signposted)
- Park in the Norwich Research Park site car park, follow the path to Earlham Institute where you can sign in at EI reception and **register your car** for onsite parking.

From the A11

- Stay on A11 until you reach the Thickthorn Services roundabout
- At roundabout take 2nd exit A47 (signposted Swaffham)
- At the junction with B1108 (Watton rd) branch left (signposted Norwich) and at the roundabout take 3rd exit B1108
- At the next roundabout take the 1st exit, signposted Norwich, University of East Anglia
- Turn right at the second set of traffic lights and then right into the Norwich Research Park (signposted)
- Park in the Norwich Research Park site car park, follow the path to Earlham Institute where you can sign in at EI reception and **register your car** for onsite parking.

Public transport.

National rail information

Norwich has a direct link to London with an average journey time of 2 hours, with trains at half-hourly intervals.

First Group Information

First Bus, Number 26 from Stop DF/DE at the Train Station goes directly to the Norwich Research Park Number 25 from the same stop goes to UEA, Chancellors Drive. Earlham Institute, is a 10 - 15 minute walk from there.

25 | 26

From Norwich City Centre

Konect Bus service

Bus numbers 3 and 4 operate a service from Norwich Bus Station in the city, to the Norfolk and Norwich University Hospital (NNUH)

3 | 4

First Bus service

Bus Numbers 21/21A operate a service from Castle Meadow in the city centre (Stop CS) and both stop at the NNUH and the NRP on Colney lane.

21 | 21_a

Please contact our Business Support team or your host if you have further questions.







business.support@earlham.ac.uk

Site map

If you require an accessible parking space please contact Business Support to pre-book.

On arrival at the barrier you can use the intercom to contact our Business Support team to let them know you have arrived.

For all other parking please use the staff and visitor car park.

-  Earlham Institute
-  Accessible route to EI
-  Barrier
-  Accessible parking
-  Staff and visitor parking
-  Bicycle storage
-  Electric charging point

Email business.support@earlham.ac.uk
or call us on 01603 450001.

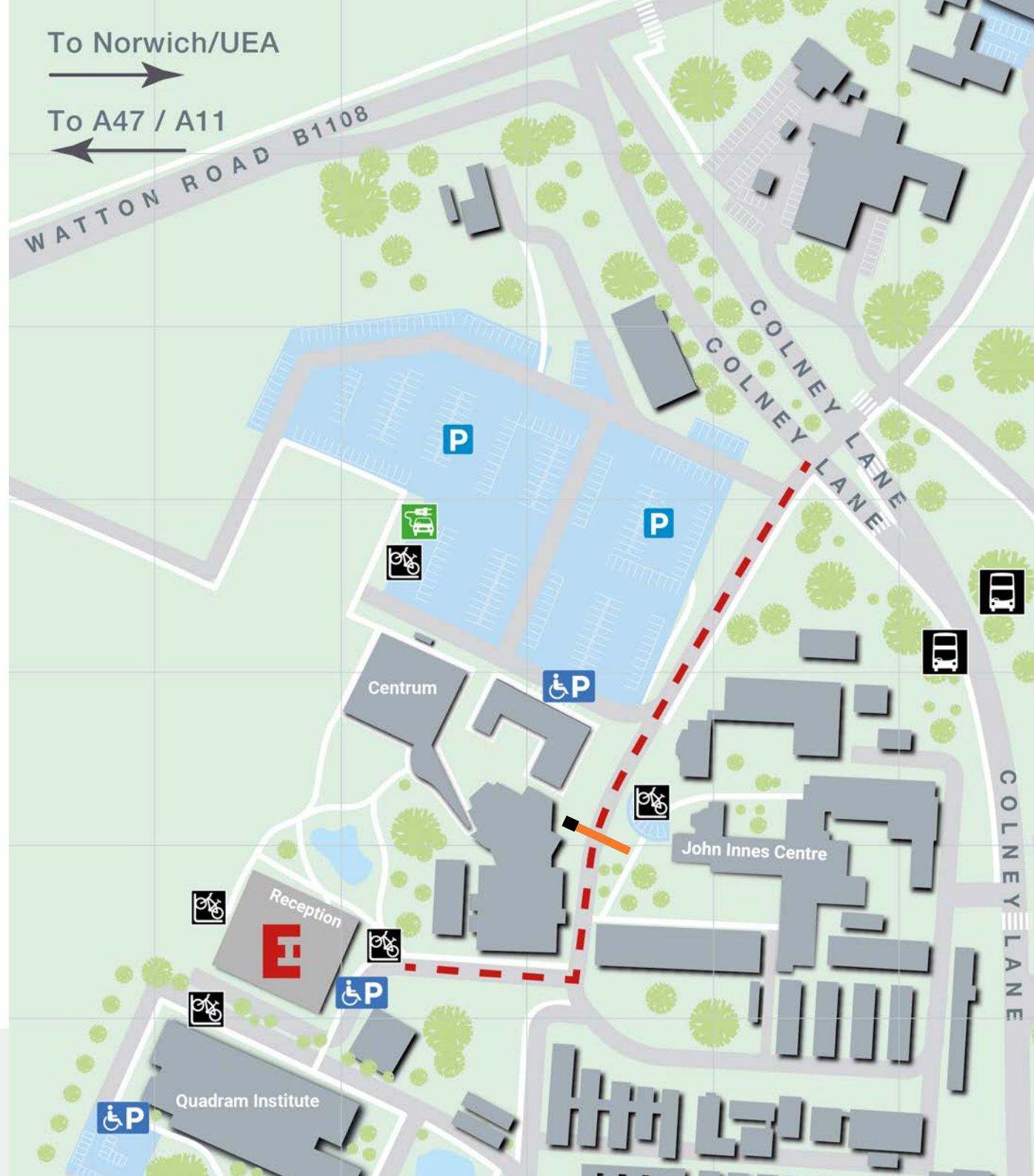

Our floor plan

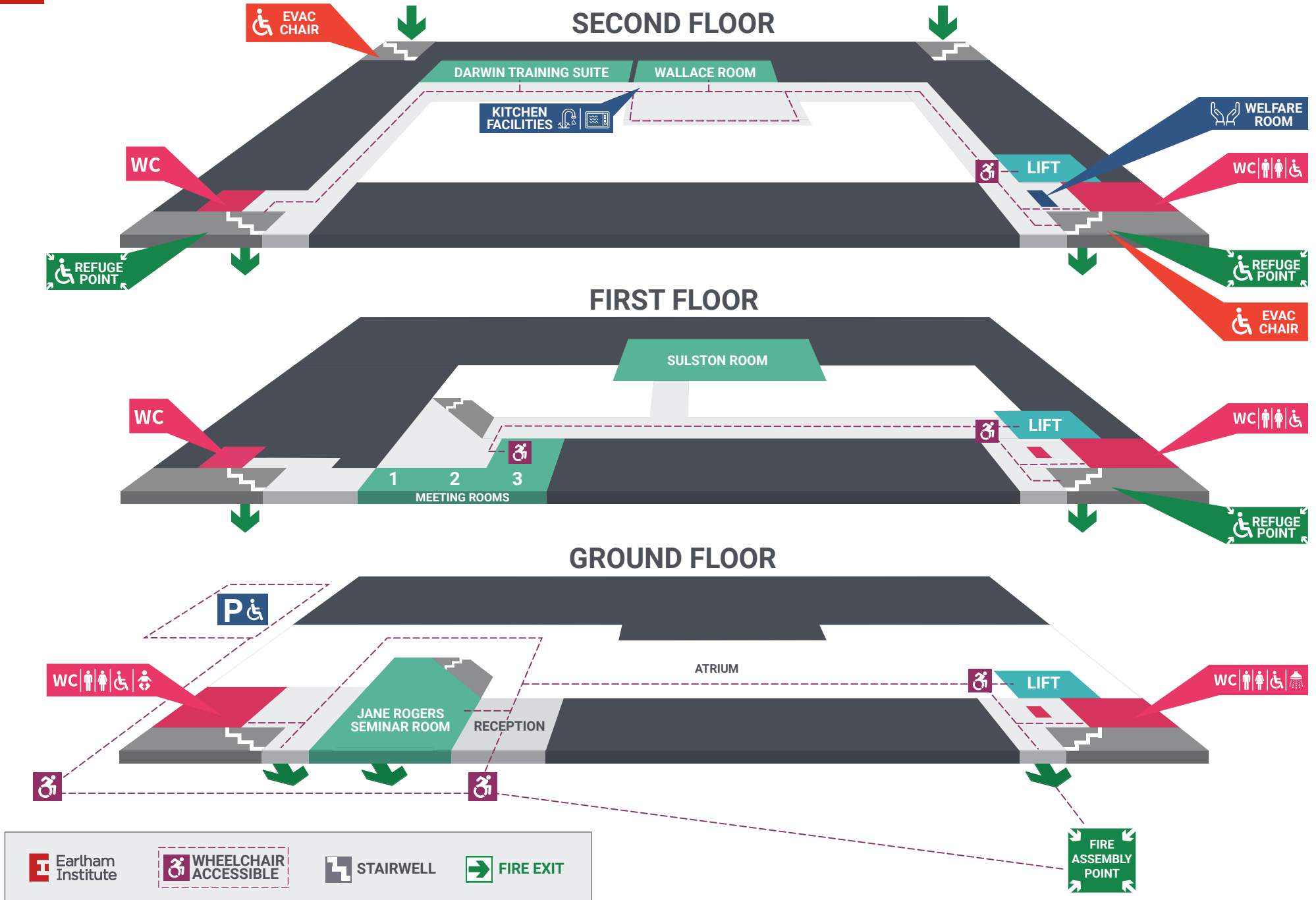

Earlham Institute

Decoding Living Systems



Earlham Institute, Norwich Research Park
Colney Lane, Norwich, Norfolk, NR4 7UZ

Tel: 01603 450 001
earlham.ac.uk

